

# Graphs (MyCricket LiveScore Tablet)

[MyCricket LiveScore FAQ](#)

## Wagon Wheels

### Plotting

If the 'show wagon wheel' setting is turned on, you will be asked to plot where the ball went after each scoring shot. Simply tap where this is on the oval and hit 'Done'.

If you do not wish to record a shot on the wagon wheel, tap cancel to return to the scoring page to score the next delivery.

**Note**

Users can turn on/off wagon wheels via the 'Match Settings' menu item

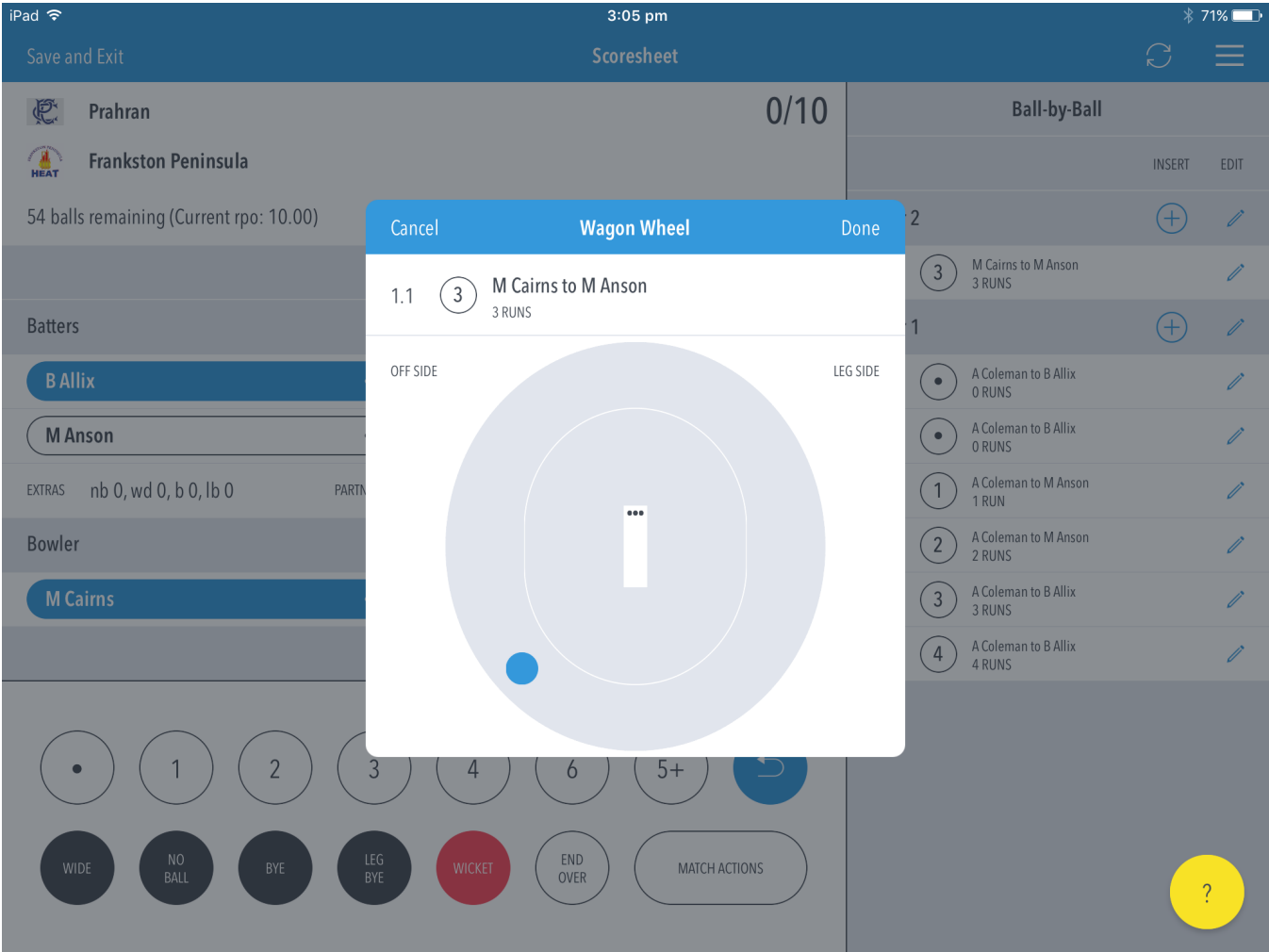

### Viewing

Users can view a batters wagon wheel by selecting the graphs button via the three dot icon next to the strike batters or via the edit scorecard page.



The screenshot shows the Cricket Score App interface. At the top, the status bar indicates 'Pad', signal strength, time '3:02 pm', and battery '71%'. The app's header is blue with 'Save and Exit' on the left, 'ScoreSheet' in the center, and a refresh icon and menu icon on the right. The main content area is divided into two sections. The left section shows the match details: 'Prahran' (with a logo) vs 'Frankston Peninsula' (with a logo). The score is '0/10'. Below this, it says '54 balls remaining (Current rpo: 10.00)' and 'Projected: 100 >'. The right section is titled 'Ball-by-Ball' and shows 'Over 2' and 'Over 1' with a list of balls and runs. A modal menu is open in the center, with options: 'Change strike', 'Change batter', 'Graphs' (highlighted with a red border), and 'Cancel'. The bottom of the screen features a control panel with buttons for ball types (dot, 1, 2, 3, 4, 6, 5+), a blue circular button with a curved arrow, and buttons for 'WIDE', 'NO BALL', 'BYE', 'LEG BYE', 'WICKET' (red), 'END OVER', and 'MATCH ACTIONS'. A yellow circular button with a question mark is in the bottom right corner.

The 'Scoring Zones' groups runs based on sections within the ground.